

CITY OF TURLOCK

CAPITAL PROJECT NO. 23-057

MONTE VISTA BIKE LANE IMPROVEMENTS NEAR CSUS

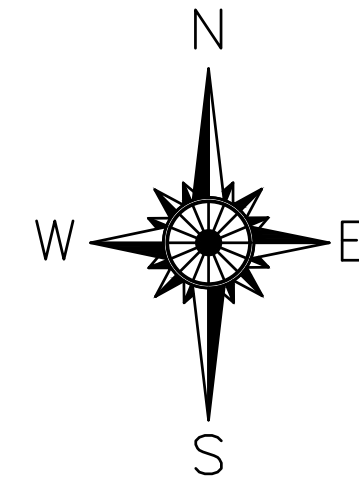

VICINITY MAP

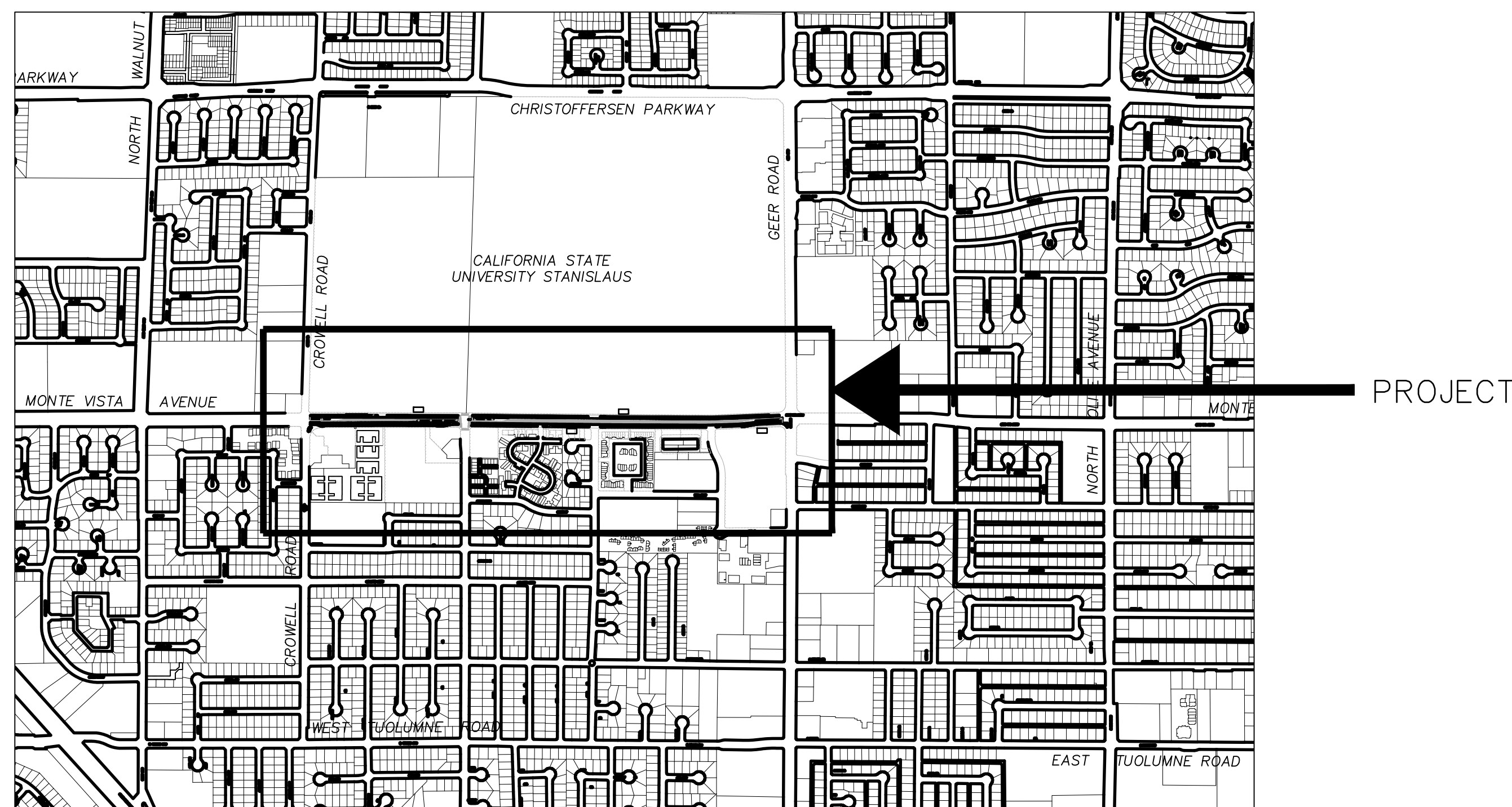

NOT TO SCALE

LEGEND

- PROPOSED STRIPING
- EXISTING CURB, GUTTER, OR SIDEWALK
- EXISTING STRIPING
- INDICATES CHANGE IN STRIPING DETAIL
- AREA TO CRACK SEALED FOLLOWED BY TYPE II SLURRY SEAL

CONTACTS

- CITY OF TURLOCK, ENGINEERING DIVISION
209-668-5520
- FIRE DEPARTMENT (NON-EMERGENCY)
209-668-5580
- POLICE DEPARTMENT (NON-EMERGENCY)
209-668-1200
- AMBULANCE
209-632-2271
- TURLOCK SCAVENGER
209-668-7274
- TURLOCK TRANSIT
209-668-5600

ABBREVIATIONS

- APN ASSESSORS PARCEL NUMBER
- BSW BACK OF SIDEWALK
- CL CENTERLINE
- DET DETAIL
- EX EXISTING
- FL FLOWLINE
- LF LINEAR FOOT
- ROW RIGHT OF WAY
- SF SQUARE FEET
- TOC TOP OF CURB
- TYP TYPICAL

SHEET INDEX

SHEET	DESCRIPTION
1	SHEET INDEX, LEGEND, & VICINITY MAP
2	STRIPING PLAN I
3	STRIPING PLAN II
4	STRIPING PLAN III
5	STRIPING PLAN IV
6	CONSTRUCTION DETAILS
7	CONSTRUCTION DETAILS

CITY OF TURLOCK NOTES

1. ALL IMPROVEMENTS SHALL BE DONE IN ACCORDANCE WITH THE REQUIREMENTS OF THE CITY OF TURLOCK'S STANDARD SPECIFICATION AND THE CURRENT EDITION OF THE STATE OF CALIFORNIA DEPARTMENT OF TRANSPORTATION STANDARD SPECIFICATIONS.
2. WHERE THE PLANS OR SPECIFICATIONS DESCRIBE PORTIONS OF THE WORK IN GENERAL TERMS, BUT NOT IN COMPLETE DETAIL, IT IS UNDERSTOOD THAT ONLY THE BEST GENERAL PRACTICE IS TO PREVAIL AND THAT ONLY MATERIALS AND WORKMANSHIP OF THE FINEST QUALITY ARE TO BE USED.
3. THE CONTRACTOR AGREES TO ASSUME SOLE AND COMPLETE RESPONSIBILITY FOR JOBS SITE CONDITIONS DURING THE COURSE OF CONSTRUCTION OF THIS PROJECT, INCLUDING SAFETY OF ALL PERSONS AND PROPERTY; THAT THIS REQUIREMENT SHALL APPLY CONTINUOUSLY AND NOT BE LIMITED TO NORMAL WORKING HOURS.
4. THE CONTRACTOR SHALL NOTIFY ADJACENT PROPERTY OWNERS, TURLOCK SCAVENGER, SCHOOLS, TURLOCK TRANSIT AND THE APPROPRIATE EMERGENCY SERVICES AGENCIES AT LEAST 72 HOURS PRIOR TO COMMENCEMENT OF WORK.
5. THE CONTRACTOR SHALL COMPLY WITH THE REQUIREMENTS OF CHAPTER 9, SECTION 6705, 6706, AND 6707 OF THE STATE LABOR CODE.
6. THE CONTRACTOR WILL CAT-TRACK (PREMARKING) DURING THE CONSTRUCTION PHASE OF THE PROJECT.
7. CONTRACTOR WILL ABIDE BY THE CURRENT CALIFORNIA MUTCD FOR REFERENCE TO DETAILS.
8. STRIPING AND SHADED AREAS TO BE SEALED ARE DIAGRAMMATIC ONLY. SLURRY SEAL SHALL BE PLACED BETWEEN THE LIP OF GUTTERS, AND SHALL END AT CURB RETURNS, UNLESS OTHERWISE NOTED.
9. CRACK TREATMENT - CRACK TREATMENT WORK SHALL CONFORM TO TYPE 2 PER SECTION 37-6 "CRACK TREATMENTS" OF THE CALTRANS STANDARD SPECIFICATIONS. CRACK TREATMENT SHALL BE ALLOWED TO CURE FOR A MINIMUM OF 72 HOURS PRIOR TO APPLYING PAVEMENT SURFACE TREATMENT. IF THE CRACK TREATMENT MATERIAL IS ACCEPTED BASED ON A CERTIFICATE OF COMPLIANCE, QUALITY ASSURANCE TESTING IS NOT REQUIRED BY THE CITY. IF THE MATERIAL IS NOT ACCEPTED BASED ON A CERTIFICATE OF COMPLIANCE, THE CITY WILL PERFORM QUALITY ASSURANCE TESTING PER SECTION 37-6.01D OF THE CALTRANS STANDARDS SPECIFICATIONS.
10. SLURRY SEAL - SLURRY SEAL SHALL CONFORM TO TYPE II PER THE PROVISIONS IN SECTION 37-3, "SLURRY SEAL AND MICRO-SURFACINGS", OF THE CALTRANS STANDARD SPECIFICATIONS AND THE SPECIAL PROVISIONS. THE SLURRY SEAL AREA SHALL BE CONSIDERED AS THE ENTIRE WIDTH OF ROADWAY AND SHALL EXTEND THE FULL LENGTH OF THE STREET TO THE LIMITS OF THE ADJACENT STREET UNLESS OTHERWISE INDICATED. ASPHALTIC EMULSION SHALL BE TYPE PMCQ5TH AND SHALL CONFORM TO THE REQUIREMENTS IN SECTION 94, "ASPHALTIC EMULSIONS," OF THE CALTRANS STANDARD SPECIFICATIONS.
11. TEMPORARY PAVEMENT STRIPING AND MARKINGS - THE CONTRACTOR SHALL FURNISH, PLACE, MAINTAIN AND REMOVE TEMPORARY MARKINGS (TAPE) IN ACCORDANCE WITH INDUSTRY STANDARD ACCEPTED PRACTICES. NOTHING IN THESE SPECIAL PROVISIONS SHALL BE CONSTRUED AS TO REDUCE THE MINIMUM STANDARDS SPECIFIED IN THE CALIFORNIA MUTCD FOR STREETS AND HIGHWAYS. TEMPORARY PAVEMENT DELINEATION SHALL NOT BE APPLIED OVER EXISTING MARKINGS, AND SHALL BE MAINTAINED UNTIL REPLACED WITH PERMANENT ONE. ANY TEMPORARY PAVEMENT MARKING CONFLICTING WITH NEW TRAFFIC PATTERN SHALL BE PROMPTLY REMOVED, OR REMOVED AS DIRECTED BY THE ENGINEER.
12. THERMOPLASTIC STRIPING AND MARKINGS - ALL TRAFFIC STRIPES AND PAVEMENT MARKINGS SHALL CONFORM TO SECTION 84, "MARKINGS," OF THE CALTRANS STANDARD SPECIFICATIONS. PERMANENT THERMOPLASTIC STRIPING AND MARKINGS IN A GIVEN AREA SHALL BE PLACED NO MORE THAN SEVEN (7) CALENDAR DAYS AFTER COMPLETION OF PAVING WORK IN THAT GIVEN AREA. TRAFFIC STRIPING SHALL BE MEASURED BY THE LINEAR FOOT, RESPECTIVE TO THE DETAIL ON THE CALTRANS STANDARD PLANS. PAVEMENT MARKINGS SHALL BE MEASURED BY THE SQUARE FOOT IN ACCORDANCE WITH THE CALTRANS STANDARD PLANS.
13. PAVEMENT MARKERS - ALL PAVEMENT MARKERS SHALL CONFORM TO SECTION 84, "MARKINGS," OF THE CALTRANS STANDARD SPECIFICATIONS. CONTRACTOR SHALL INSTALL BLUE RAISED REFLECTIVE PAVEMENT MARKERS (TYPE BB) TO MARK FIRE HYDRANT LOCATIONS. THE BLUE REFLECTIVE PAVEMENT MARKERS SHALL BE PLACED PER CITY STANDARD W-3. PERMANENT PAVEMENT MARKERS IN A GIVEN AREA SHALL BE PLACED NO MORE THAN SEVEN (7) CALENDAR DAYS AFTER COMPLETION OF PAVING WORK IN THAT GIVEN AREA.
14. STREET SWEEPING - AT LEAST 48 HOURS PRIOR TO THE BEGINNING OF VACUUMING AND SWEEPING, THE CONTRACTOR SHALL POST ALL PARKING AREAS THAT ARE TO BE WORKED UPON WITH APPROVED, "NO PARKING - TOW AWAY" SIGN. THESE SIGNS SHALL ALSO STATE THE DAY OF THE WEEK AND HOURS OF NO PARKING. A COPY OF SAID NOTICE SHALL BE SUPPLIED TO THE CITY AT THE PRE-CONSTRUCTION MEETING. CONTRACTOR SHALL SUBMIT A STREET SWEEPING SCHEDULE FOR THE CITY'S REVIEW. THOROUGHLY VACUUM AND SWEEP ALL ASPHALTIC EMULSION PAVEMENTS PRIOR TO STRIPING, OR 2 WEEKS AFTER THE ASPHALTIC EMULSION PLACEMENT, WHICHEVER IS SOONER. THOROUGHLY VACUUM AND SWEEP ALL ASPHALTIC EMULSION PAVEMENTS 2 WEEK AFTER STRIPING.
15. FINAL CLEAN UP - UPON COMPLETION OF THE WORK, THE CONTRACTOR SHALL REMOVE ALL EQUIPMENT, DEBRIS, AND SHALL LEAVE THE SITE IN A NEAT CLEAN CONDITION TO THE SATISFACTION OF THE ENGINEER. THE CONTRACTOR SHALL CLEAN THE AREA OF ALL CONSTRUCTION RELATED MATERIALS AND SWEEP THE ENTIRE PROJECT AREA INCLUDING SIDEWALK AND GUTTER THOROUGHLY. ALL CONSTRUCTION SIGNS, CONES, BARRICADES, AND CONFLICTING MARKINGS SHALL BE REMOVED.



NOTE:
ALL REFERENCES AND WRITTEN DIMENSIONS SHALL TAKE PREFERENCE OVER SCALED DIMENSIONS AND SHALL BE VERIFIED IN THE FIELD. ANY DISCREPANCY SHALL BE BROUGHT TO NOTICE OF THE ENGINEER PRIOR TO THE COMMENCEMENT OF ANY WORK.

REVIEWED BY:

STEPHEN FREMMING, P.E.
PRINCIPAL CIVIL ENGINEER
9/18/2024
DATE

APPROVED BY:

WILLIAM D. MORRIS, RCE 55910
CITY ENGINEER
9/18/2024
PLANS APPROVAL DATE



CITY OF TURLOCK
ENGINEERING DIVISION
156 S. BROADWAY, STE 150
(209) 668-5520

SHEET INDEX, LEGEND, & VICINITY MAP

CAPITAL PROJECT NO. 23-057
MONTE VISTA BIKE LANE
IMPROVEMENTS NEAR CSUS

VERIFY SCALE
BAR IS 1" ON ORIGINAL DRAWING
0 1/4" 3/4" 1"
1/2"
IF NOT ONE INCH ON THIS SHEET, ADJUST SCALE ACCORDINGLY

DRAWN BY: OM
REV. BY: SF
CH. BY: BM
DATE: 9/17/2024
SCALE: NOT TO SCALE

SHEET
1
OF 7

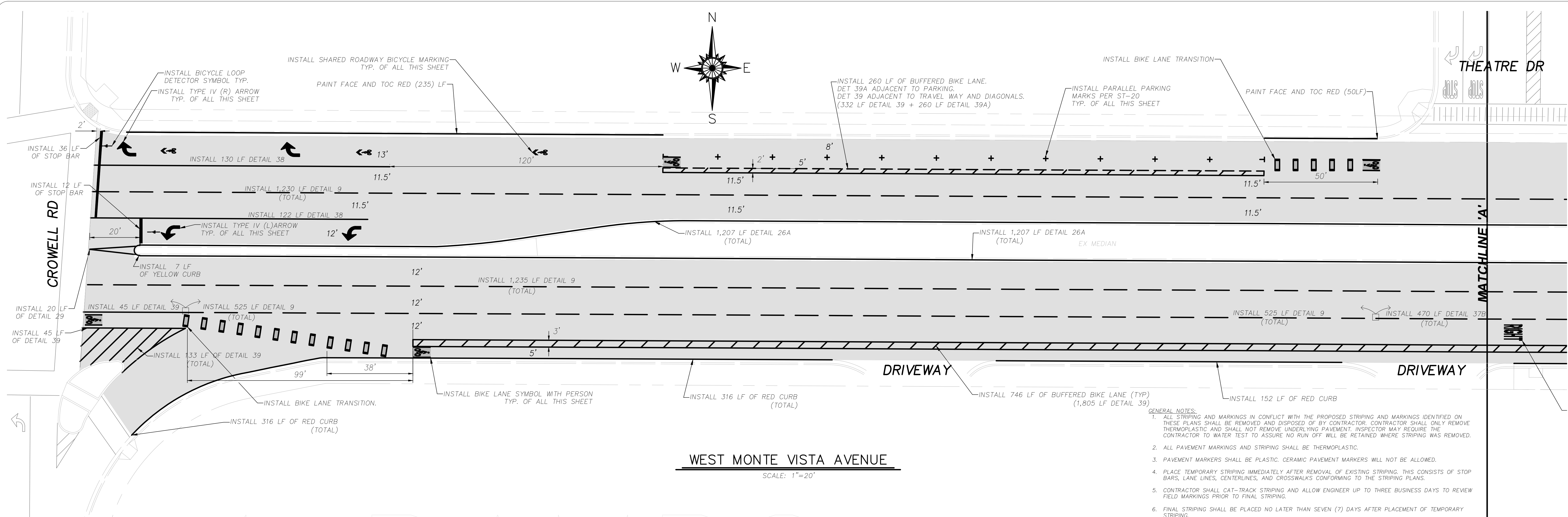

WEST MONTE VISTA AVENUE
SCALE: 1"=20'

- GENERAL NOTES:**
1. ALL STRIPING AND MARKINGS IN CONFLICT WITH THE PROPOSED STRIPING AND MARKINGS IDENTIFIED ON THESE PLANS SHALL BE REMOVED AND DISPOSED OF BY CONTRACTOR. CONTRACTOR SHALL ONLY REMOVE THERMOPLASTIC AND SHALL NOT REMOVE UNDERLYING PAVEMENT. INSPECTOR MAY REQUIRE THE CONTRACTOR TO WATER TEST TO ASSURE NO RUN OFF WILL BE RETAINED WHERE STRIPING WAS REMOVED.
 2. ALL PAVEMENT MARKINGS AND STRIPING SHALL BE THERMOPLASTIC.
 3. PAVEMENT MARKERS SHALL BE PLASTIC. CERAMIC PAVEMENT MARKERS WILL NOT BE ALLOWED.
 4. PLACE TEMPORARY STRIPING IMMEDIATELY AFTER REMOVAL OF EXISTING STRIPING. THIS CONSISTS OF STOP BARS, LANE LINES, CENTERLINES, AND CROSSWALKS CONFORMING TO THE STRIPING PLANS.
 5. CONTRACTOR SHALL CAT-TRACK STRIPING AND ALLOW ENGINEER UP TO THREE BUSINESS DAYS TO REVIEW FIELD MARKINGS PRIOR TO FINAL STRIPING.
 6. FINAL STRIPING SHALL BE PLACED NO LATER THAN SEVEN (7) DAYS AFTER PLACEMENT OF TEMPORARY STRIPING.
 7. SEE DETAILS ON SHEET 6 AND 7.
 8. CONTRACTOR SHALL FILL IN DIVOTS FROM REMOVED MARKERS WITH BITUMINOUS MARKER ADHESIVE
 9. SEE SHEET 5 FOR QUANTITIES.

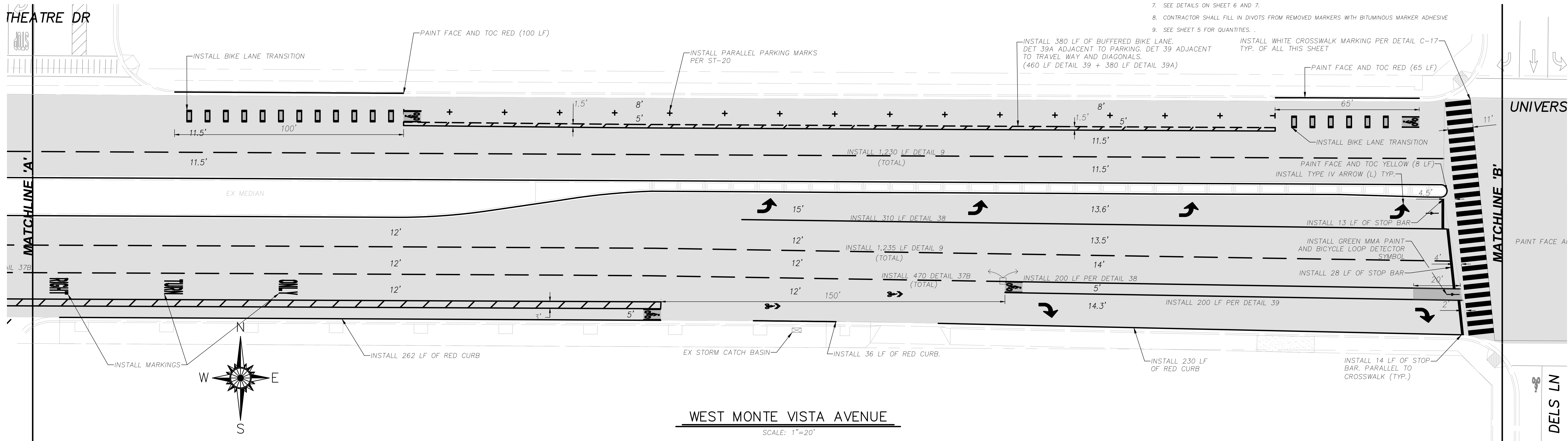

WEST MONTE VISTA AVENUE
SCALE: 1"=20'



NOTE:
ALL REFERENCES AND WRITTEN DIMENSIONS SHALL TAKE PREFERENCE OVER SCALED DIMENSIONS AND SHALL BE VERIFIED IN THE FIELD. ANY DISCREPANCY SHALL BE BROUGHT TO NOTICE OF THE ENGINEER PRIOR TO THE COMMENCEMENT OF ANY WORK.

REVIEWED BY:
Stephen Fremming
STEPHEN FREMMING, P.E.
PRINCIPAL CIVIL ENGINEER
9/18/2024
DATE

APPROVED BY:
William D. Morris
WILLIAM D. MORRIS, RCE 55910
CITY ENGINEER
9/18/2024
PLANS APPROVAL DATE



CITY OF TURLOCK
ENGINEERING DIVISION
156 S. BROADWAY, STE 150
(209) 668-5520



STRIPING PLAN I
CAPITAL PROJECT NO. 23-057
MONTE VISTA BIKE LANE
IMPROVEMENTS NEAR CSUS

VERIFY SCALE
BAR IS 1" ON ORIGINAL DRAWING
0 1/4" 3/4" 1"
IF NOT ONE INCH ON THIS SHEET, ADJUST SCALES ACCORDINGLY

DRAWN BY: OM
REV. BY: SF
CH. BY: BM
DATE: 9/17/2024
SCALE: 1" = 20'

SHEET
2
OF
7

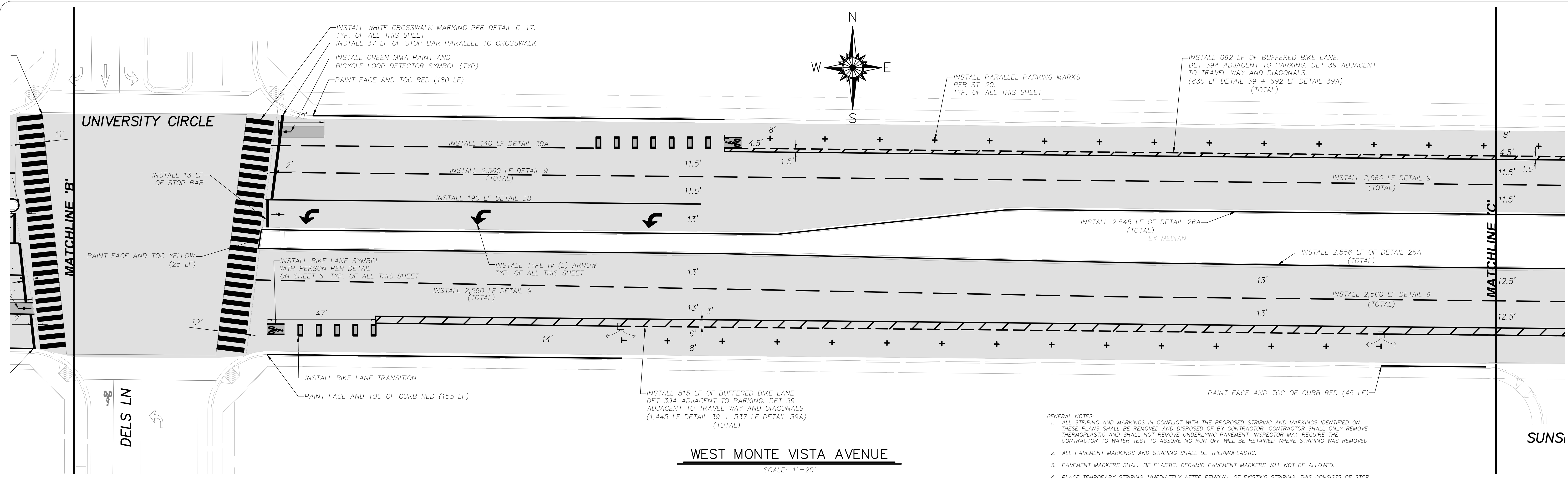

- GENERAL NOTES:**
- ALL STRIPING AND MARKINGS IN CONFLICT WITH THE PROPOSED STRIPING AND MARKINGS IDENTIFIED ON THESE PLANS SHALL BE REMOVED AND DISPOSED OF BY CONTRACTOR. CONTRACTOR SHALL ONLY REMOVE THERMOPLASTIC AND SHALL NOT REMOVE UNDERLYING PAVEMENT. INSPECTOR MAY REQUIRE THE CONTRACTOR TO WATER TEST TO ASSURE NO RUN OFF WILL BE RETAINED WHERE STRIPING WAS REMOVED.
 - ALL PAVEMENT MARKINGS AND STRIPING SHALL BE THERMOPLASTIC.
 - PAVEMENT MARKERS SHALL BE PLASTIC. CERAMIC PAVEMENT MARKERS WILL NOT BE ALLOWED.
 - PLACE TEMPORARY STRIPING IMMEDIATELY AFTER REMOVAL OF EXISTING STRIPING. THIS CONSISTS OF STOP BARS, LANE LINES, CENTERLINES, AND CROSSWALKS CONFORMING TO THE STRIPING PLANS.
 - CONTRACTOR SHALL CAT-TRACK STRIPING AND ALLOW ENGINEER UP TO THREE BUSINESS DAYS TO REVIEW FIELD MARKINGS PRIOR TO FINAL STRIPING.
 - FINAL STRIPING SHALL BE PLACED NO LATER THAN SEVEN (7) DAYS AFTER PLACEMENT OF TEMPORARY STRIPING.
 - SEE DETAILS ON SHEET 6 AND 7.
 - CONTRACTOR SHALL FILL IN DIVOTS FROM REMOVED MARKERS WITH BITUMINOUS MARKER ADHESIVE.
 - SEE SHEET 5 FOR QUANTITIES.

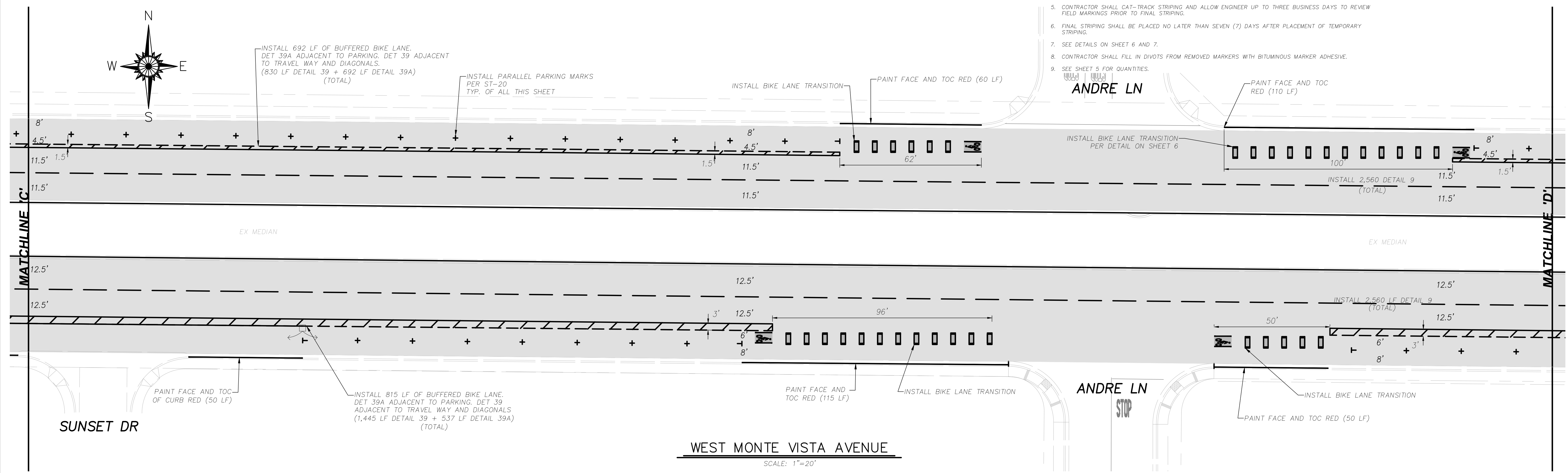

NOTE:
 ALL REFERENCES AND WRITTEN DIMENSIONS SHALL TAKE PREFERENCE OVER SCALED DIMENSIONS AND SHALL BE VERIFIED IN THE FIELD. ANY DISCREPANCY SHALL BE BROUGHT TO NOTICE OF THE ENGINEER PRIOR TO THE COMMENCEMENT OF ANY WORK.

REVIEWED BY:
 STEPHEN FREMMING, P.E.
 PRINCIPAL CIVIL ENGINEER
 9/18/2024
 DATE

APPROVED BY:
 WILLIAM D. MORRIS, RCE 55910
 CITY ENGINEER
 9/18/2024
 PLANS APPROVAL DATE



CITY OF TURLOCK
 ENGINEERING DIVISION
 156 S. BROADWAY, STE 150
 (209) 668-5520

STRIPING PLAN II
 CAPITAL PROJECT NO. 23-057
 MONTE VISTA BIKE LANE
 IMPROVEMENTS NEAR CSUS

VERIFY SCALE
 BAR IS 1" ON ORIGINAL DRAWING
 1/4" 3/4" 1" 1/2"
 IF NOT ONE INCH ON THIS SHEET, ADJUST SCALES ACCORDINGLY

DRAWN BY: OM
REV. BY: SF
CH. BY: BM
DATE: 9/17/2024
SCALE: 1" = 20'

SHEET
 3
 OF 7

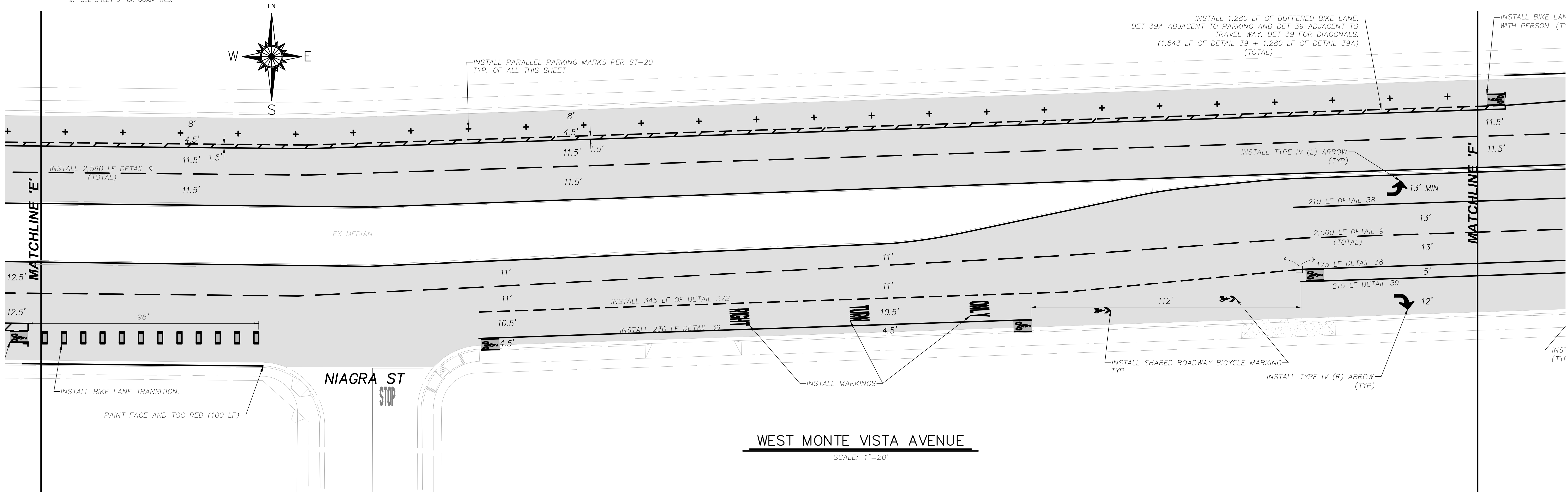
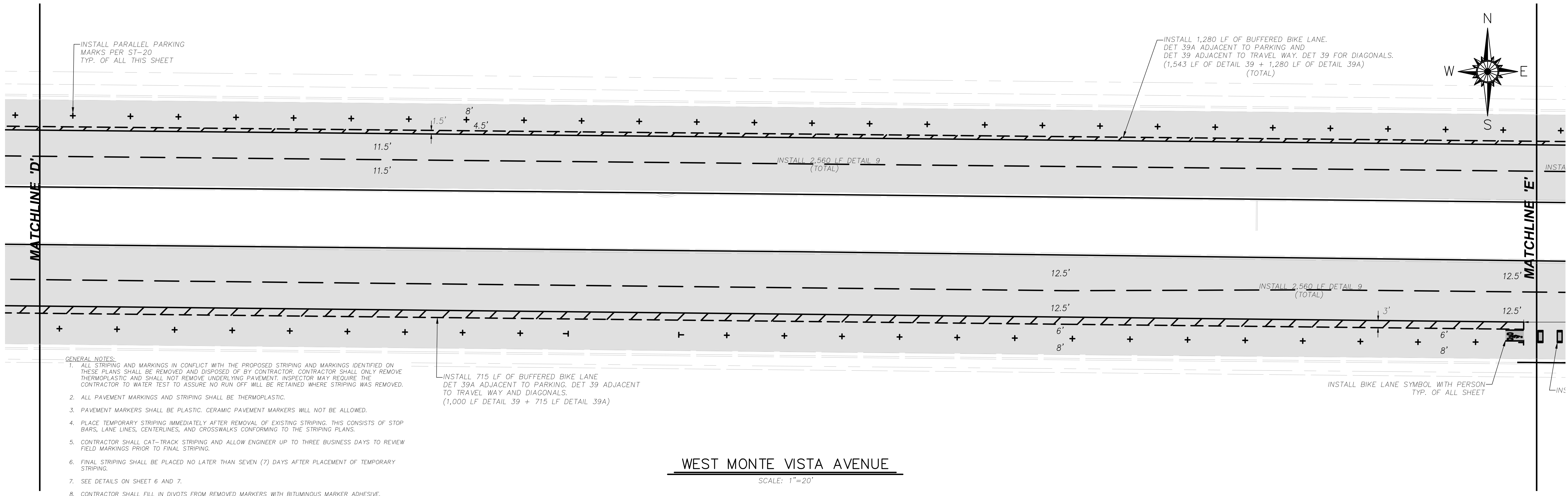

NOTE:
 ALL REFERENCES AND WRITTEN DIMENSIONS SHALL TAKE PREFERENCE OVER SCALED DIMENSIONS AND SHALL BE VERIFIED IN THE FIELD. ANY DISCREPANCY SHALL BE BROUGHT TO NOTICE OF THE ENGINEER PRIOR TO THE COMMENCEMENT OF ANY WORK.

REVIEWED BY:
 STEPHEN FREMMING, P.E.
 PRINCIPAL CIVIL ENGINEER
 9/18/2024
 DATE

APPROVED BY:
 WILLIAM D. MORRIS, RCE 55910
 CITY ENGINEER
 9/18/2024
 PLANS APPROVAL DATE



CITY OF TURLOCK
 ENGINEERING DIVISION
 156 S. BROADWAY, STE 150
 (209) 668-5520

STRIPING PLAN III
 CAPITAL PROJECT NO. 23-057
 MONTE VISTA BIKE LANE
 IMPROVEMENTS NEAR CSUS

VERIFY SCALE
 BAR IS 1" ON ORIGINAL DRAWING
 0 1/4" 3/4" 1" 1/2"

DRAWN BY: OM
 REV. BY: SF
 CH. BY: BM
 DATE: 9/17/2024
 SCALE: 1" = 20'

SHEET
 4
 OF 7

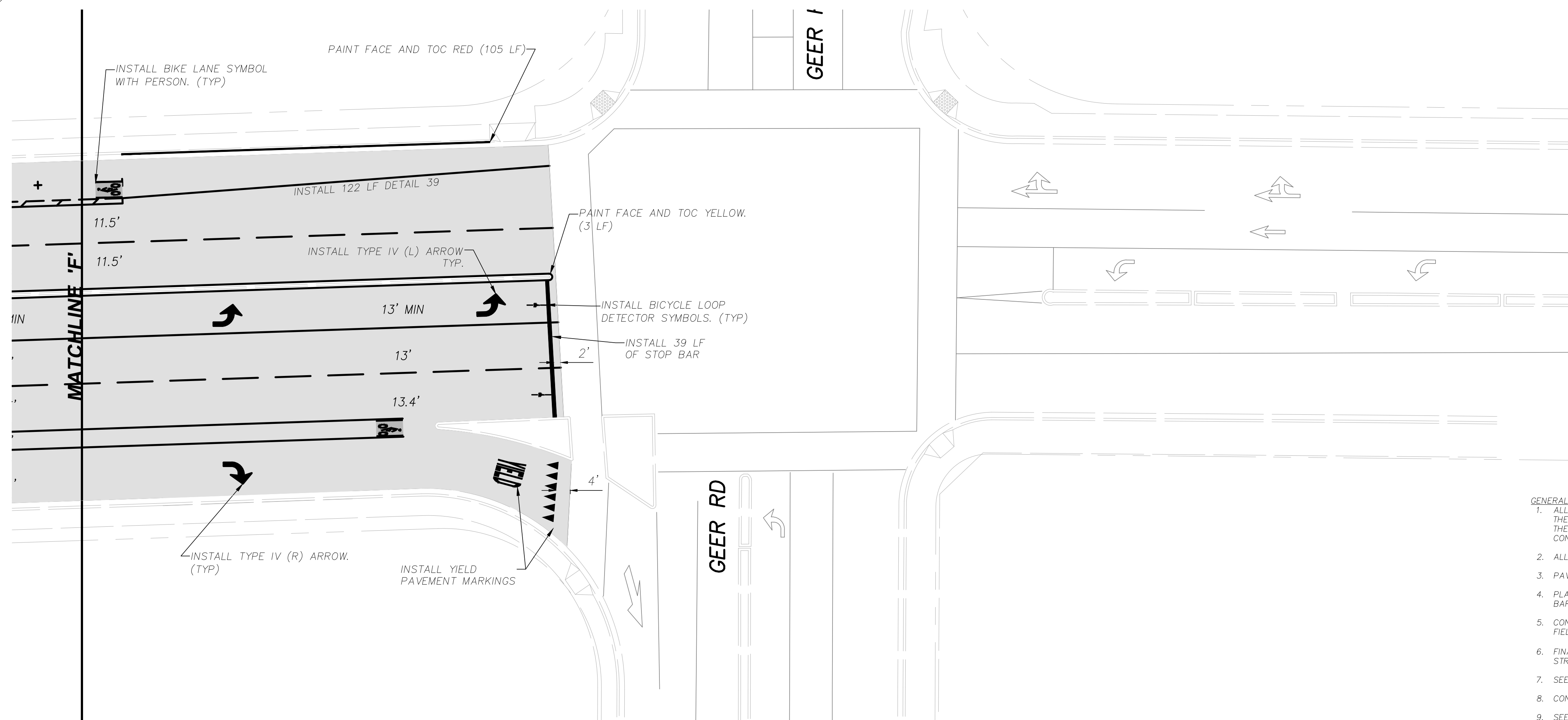
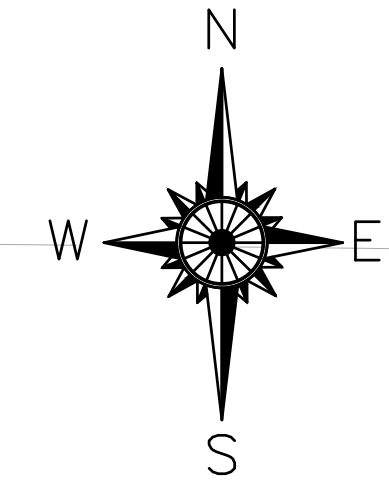

- GENERAL NOTES:**
1. ALL STRIPING AND MARKINGS IN CONFLICT WITH THE PROPOSED STRIPING AND MARKINGS IDENTIFIED ON THESE PLANS SHALL BE REMOVED AND DISPOSED OF BY CONTRACTOR. CONTRACTOR SHALL ONLY REMOVE THERMOPLASTIC AND SHALL NOT REMOVE UNDERLYING PAVEMENT. INSPECTOR MAY REQUIRE THE CONTRACTOR TO WATER TEST TO ASSURE NO RUN OFF WILL BE RETAINED WHERE STRIPING WAS REMOVED.
 2. ALL PAVEMENT MARKINGS AND STRIPING SHALL BE THERMOPLASTIC.
 3. PAVEMENT MARKERS SHALL BE PLASTIC. CERAMIC PAVEMENT MARKERS WILL NOT BE ALLOWED.
 4. PLACE TEMPORARY STRIPING IMMEDIATELY AFTER REMOVAL OF EXISTING STRIPING. THIS CONSISTS OF STOP BARS, LANE LINES, CENTERLINES, AND CROSSWALKS CONFORMING TO THE STRIPING PLANS.
 5. CONTRACTOR SHALL CAT-TRACK STRIPING AND ALLOW ENGINEER UP TO THREE BUSINESS DAYS TO REVIEW FIELD MARKINGS PRIOR TO FINAL STRIPING.
 6. FINAL STRIPING SHALL BE PLACED NO LATER THAN SEVEN (7) DAYS AFTER PLACEMENT OF TEMPORARY STRIPING.
 7. SEE DETAILS ON SHEET 6 AND 7.
 8. CONTRACTOR SHALL FILL IN DIVOTS FROM REMOVED MARKERS WITH BITUMINOUS MARKER ADHESIVE.
 9. SEE SHEET 5 FOR QUANTITIES.

WEST MONTE VISTA AVENUE

SCALE: 1"=20'

Striping																		
Sheet No.	WB/EB	Stop Bar (LF)	Detail 9 (LF)	Detail 26A (LF)	Detail 29 (LF)	Detail 37B (LF)	Detail 38 (LF)	Detail 39 (LF)	Detail 39A (LF)	Green MMA Paint (SF)	Red Curb (LF)	Parking Tees (EA)	Yellow Curb (LF)	Turn Arrow (SF)	Bike Detector Symbol (SF)	Sharrow Symbol (SF)	Crosswalks (SF)	Yield Triangles (SF)
2	WB	48	1,230	1,203	20	-	252	792	640	304	450	29	7	60	4	35	-	-
2	EB	55	1,760	1,203	-	470	510	2,228	-	321	996	-	8	90	4	23	-	-
3	WB	50	1,201	1,199	-	-	190	830	832	390	350	32	25	45	4	-	-	-
3	EB	-	1,208	1,198	-	-	-	1,445	537	266	415	28	-	-	-	-	-	-
3	INT	-	-	-	-	-	-	-	-	-	-	-	-	-	-	-	1,196	-
4	WB	-	1,222	1,222	-	-	-	1,543	1,280	30	-	51	-	-	-	-	-	-
4	EB	-	1,222	1,225	-	345	385	1,445	715	186	100	26	-	30	-	23	-	-
5	WB	-	134	133	-	-	-	122	-	30	105	1	-	-	-	-	-	-
5	EB	39	135	133	-	-	-	-	-	30	-	-	3	45	4	-	-	18
	Total	192	8,112	7,515	20	815	1,337	8,405	4,004	1,557	2,416	167	43	270	16	81	1,196	18

Sheet No.	WB/EB	Slurry & Crack Seal (SY)
2	WB	5,091
2	EB	6,715
3	Intersection	1,227
3	WB	5,103
3	EB	5,583
4	WB	4,941
4	EB	5,719
5	WB	544
5	EB	887
	TOTAL	35,810



NOTE:
ALL REFERENCES AND WRITTEN DIMENSIONS SHALL TAKE PREFERENCE OVER SCALED DIMENSIONS AND SHALL BE VERIFIED IN THE FIELD. ANY DISCREPANCY SHALL BE BROUGHT TO NOTICE OF THE ENGINEER PRIOR TO THE COMMENCEMENT OF ANY WORK.

REVIEWED BY:
Stephen Fremming
STEPHEN FREMMING, P.E.
PRINCIPAL CIVIL ENGINEER
DATE: 9/18/2024

APPROVED BY:
William D. Morris
WILLIAM D. MORRIS, RCE 55910
CITY ENGINEER
DATE: 9/18/2024
PLANS APPROVAL DATE



CITY OF TURLOCK
ENGINEERING DIVISION
156 S. BROADWAY, STE 150
(209) 668-5520

STRIPING PLAN IV
CAPITAL PROJECT NO. 23-057
MONTE VISTA BIKE LANE
IMPROVEMENTS NEAR CSUS

VERIFY SCALE
BAR IS 1" ON ORIGINAL DRAWING
0 1/4" 3/4" 1"
1/2"
IF NOT ONE INCH ON THIS SHEET, ADJUST SCALES ACCORDINGLY

DRAWN BY: OM
REV. BY: SF
CH. BY: BM
DATE: 9/17/2024
SCALE: 1" = 20'

SHEET
5
OF
7

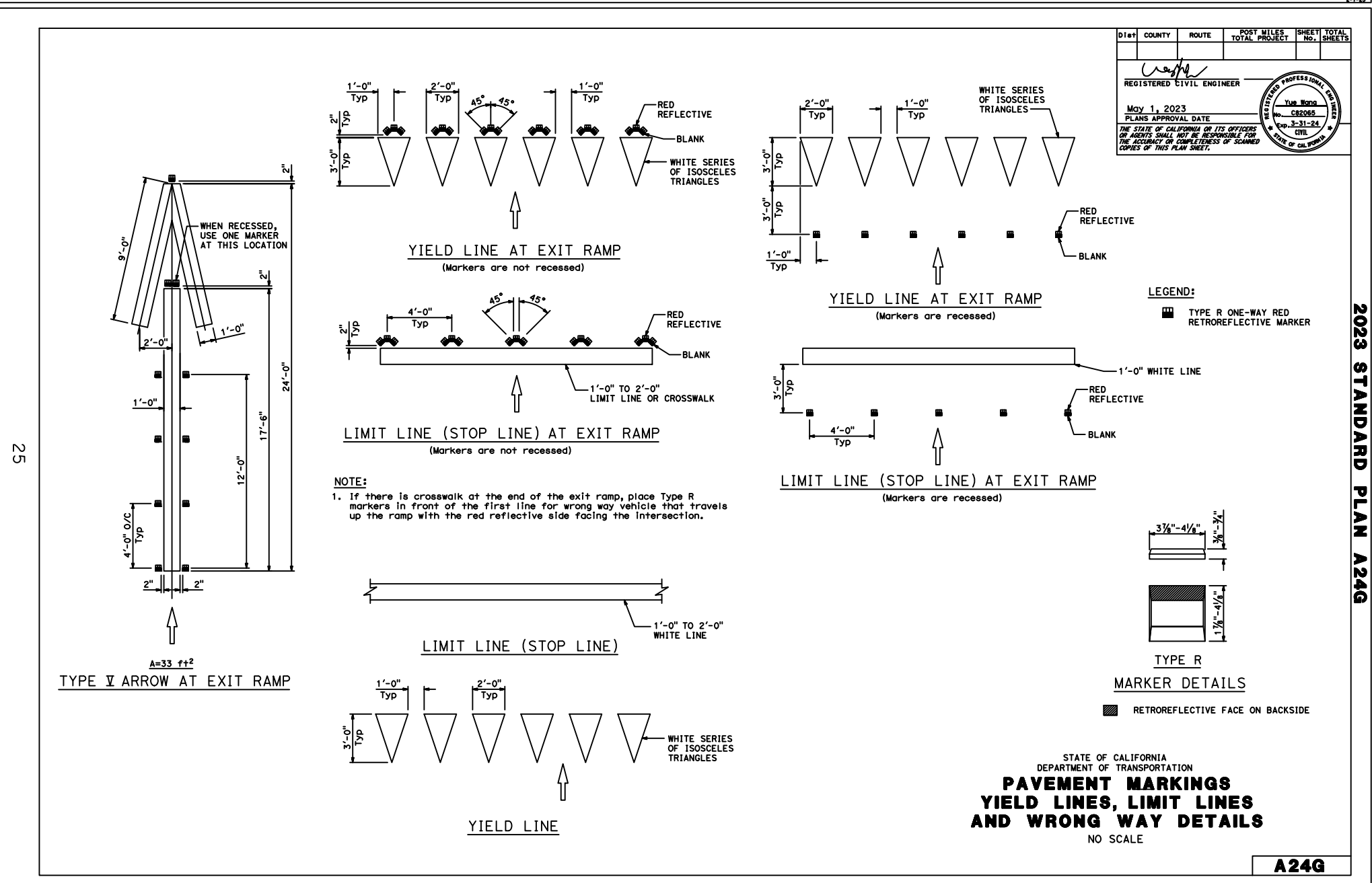
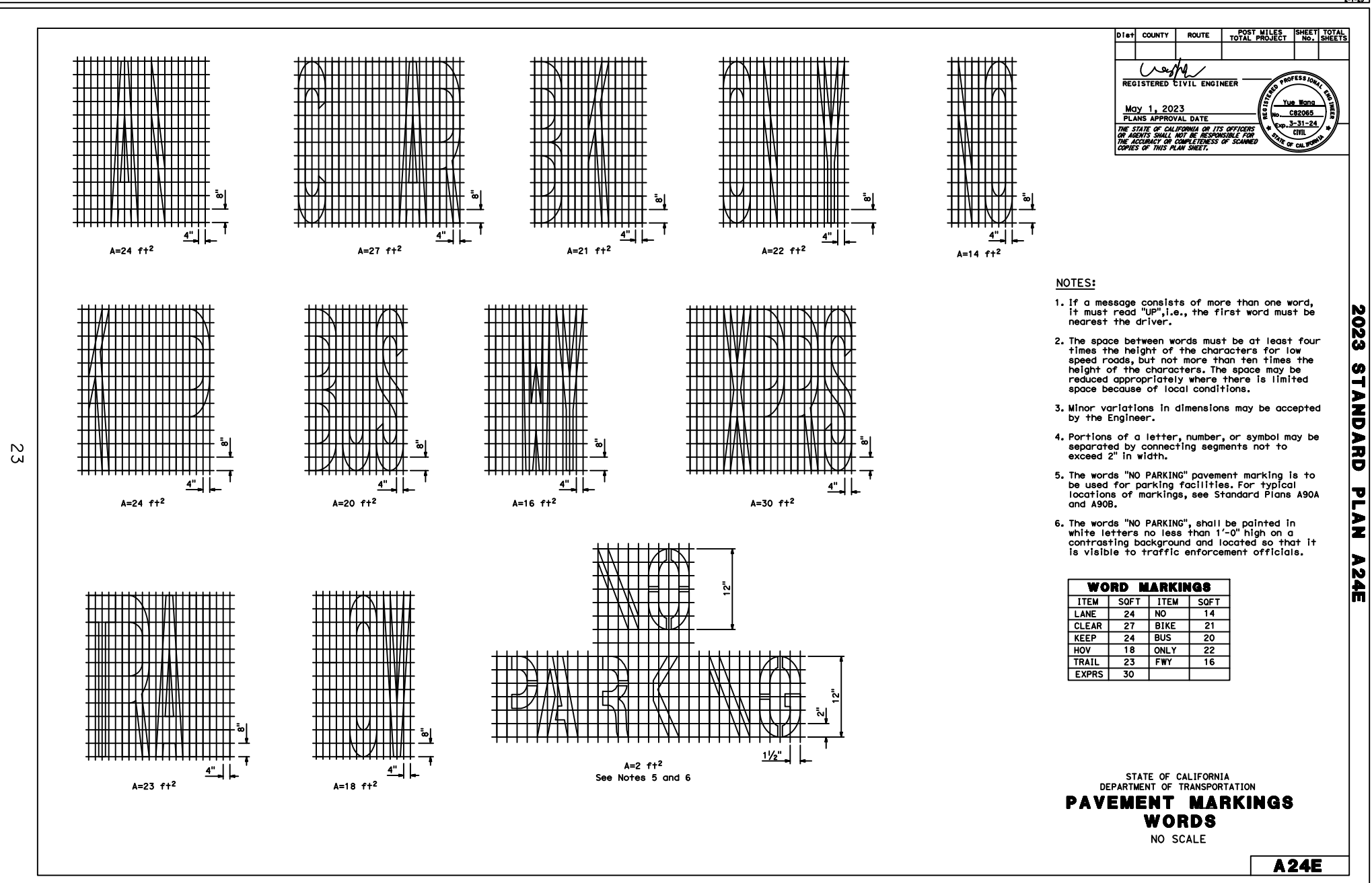
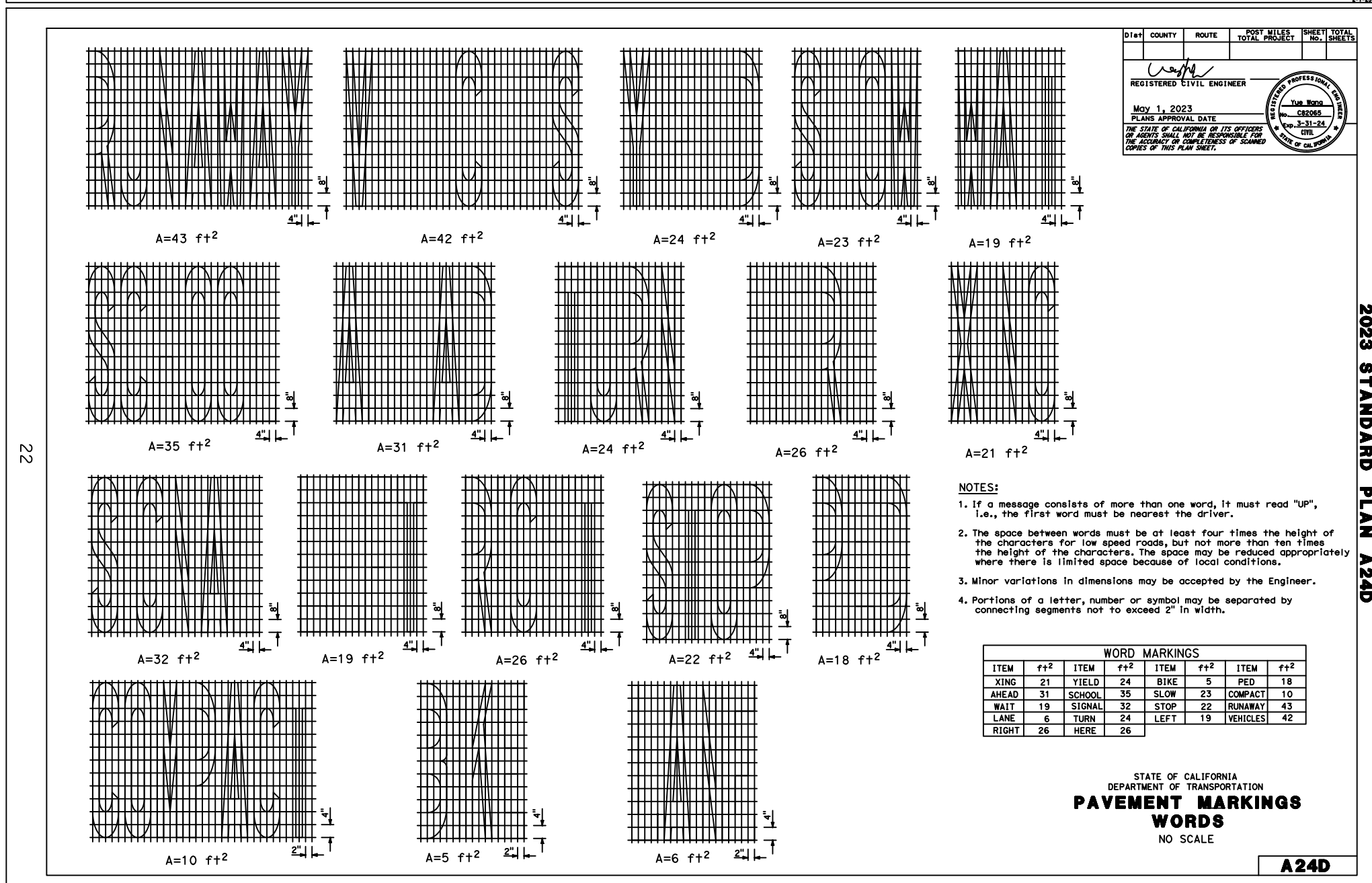
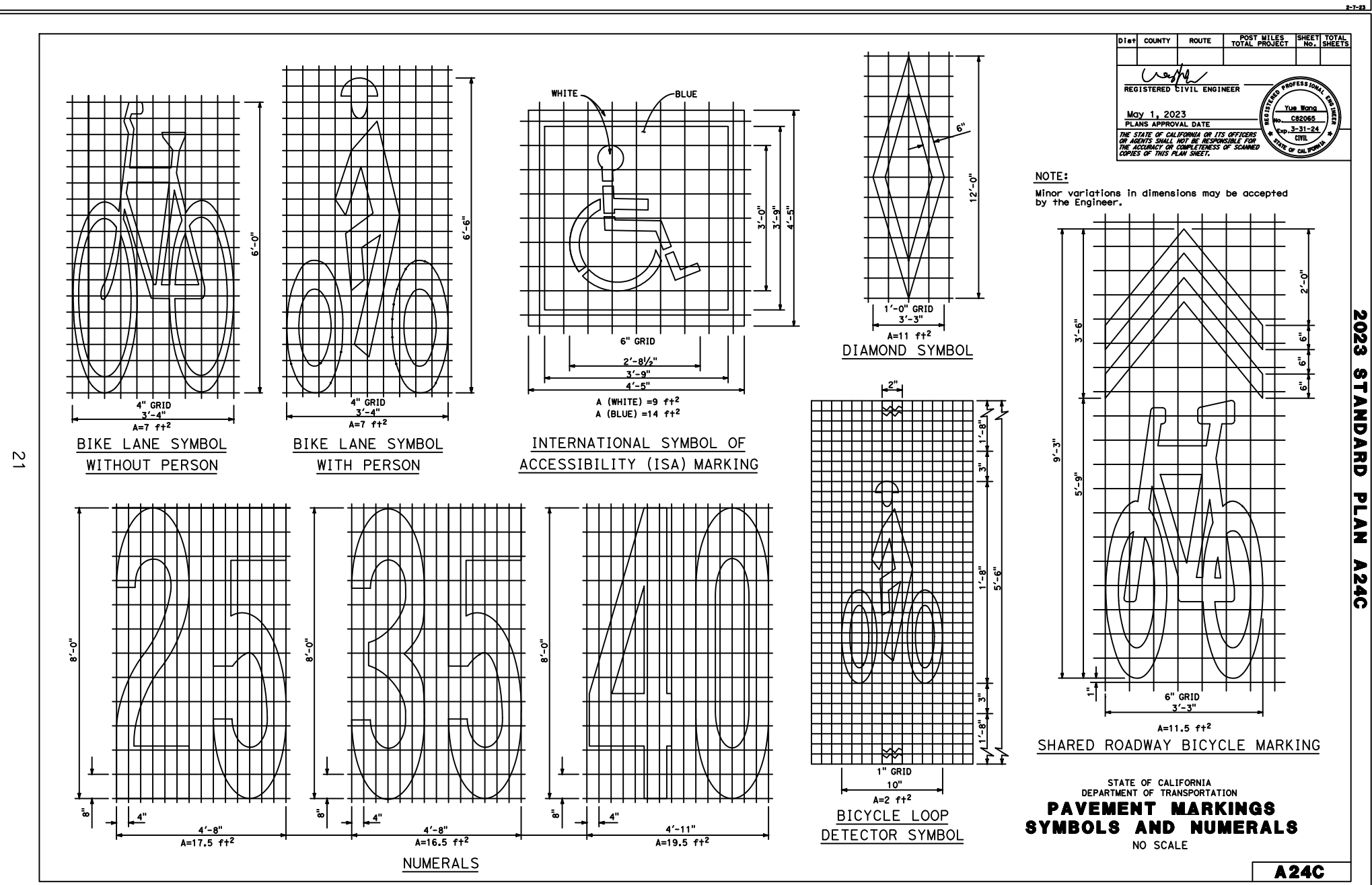
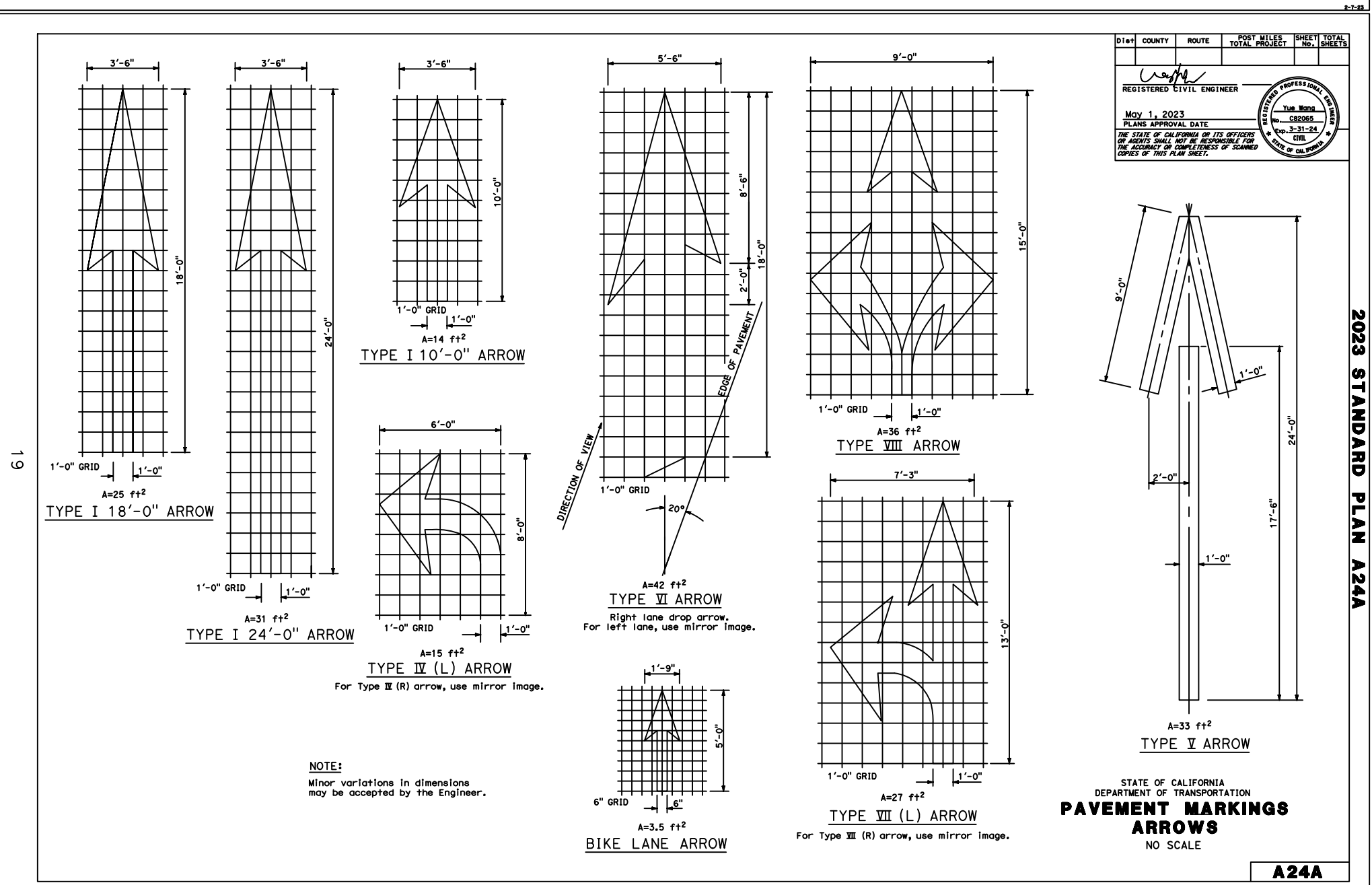
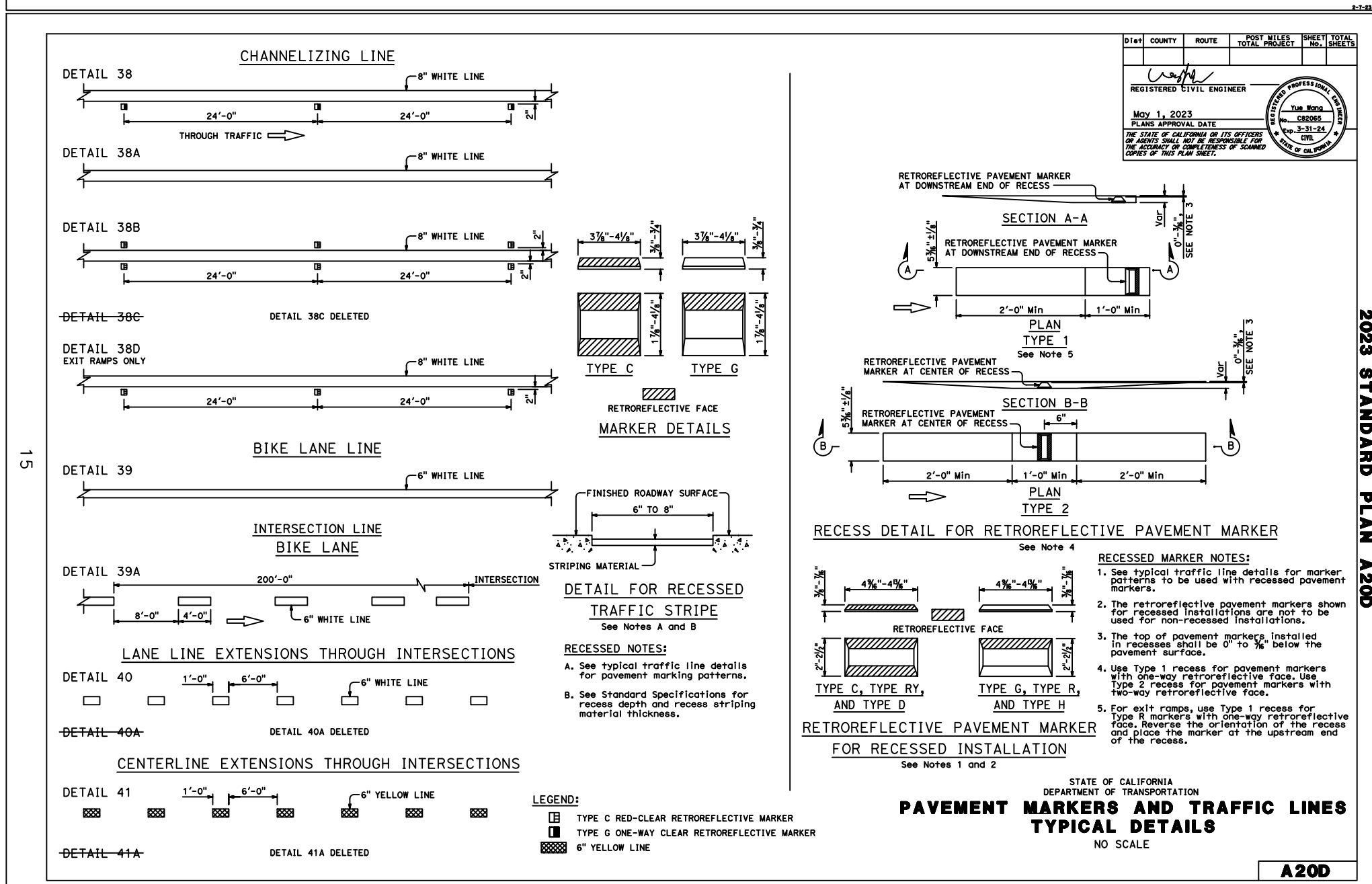
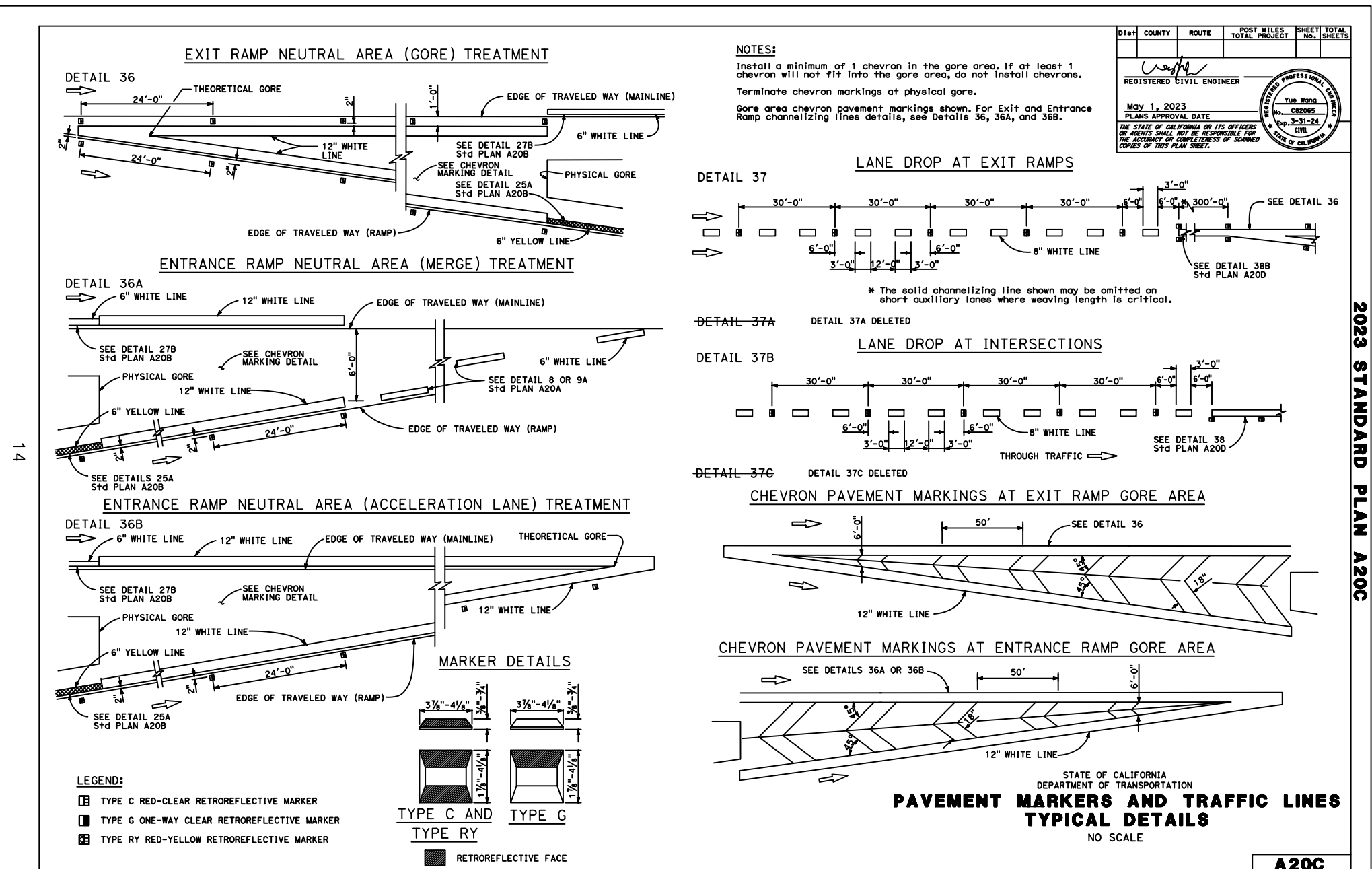
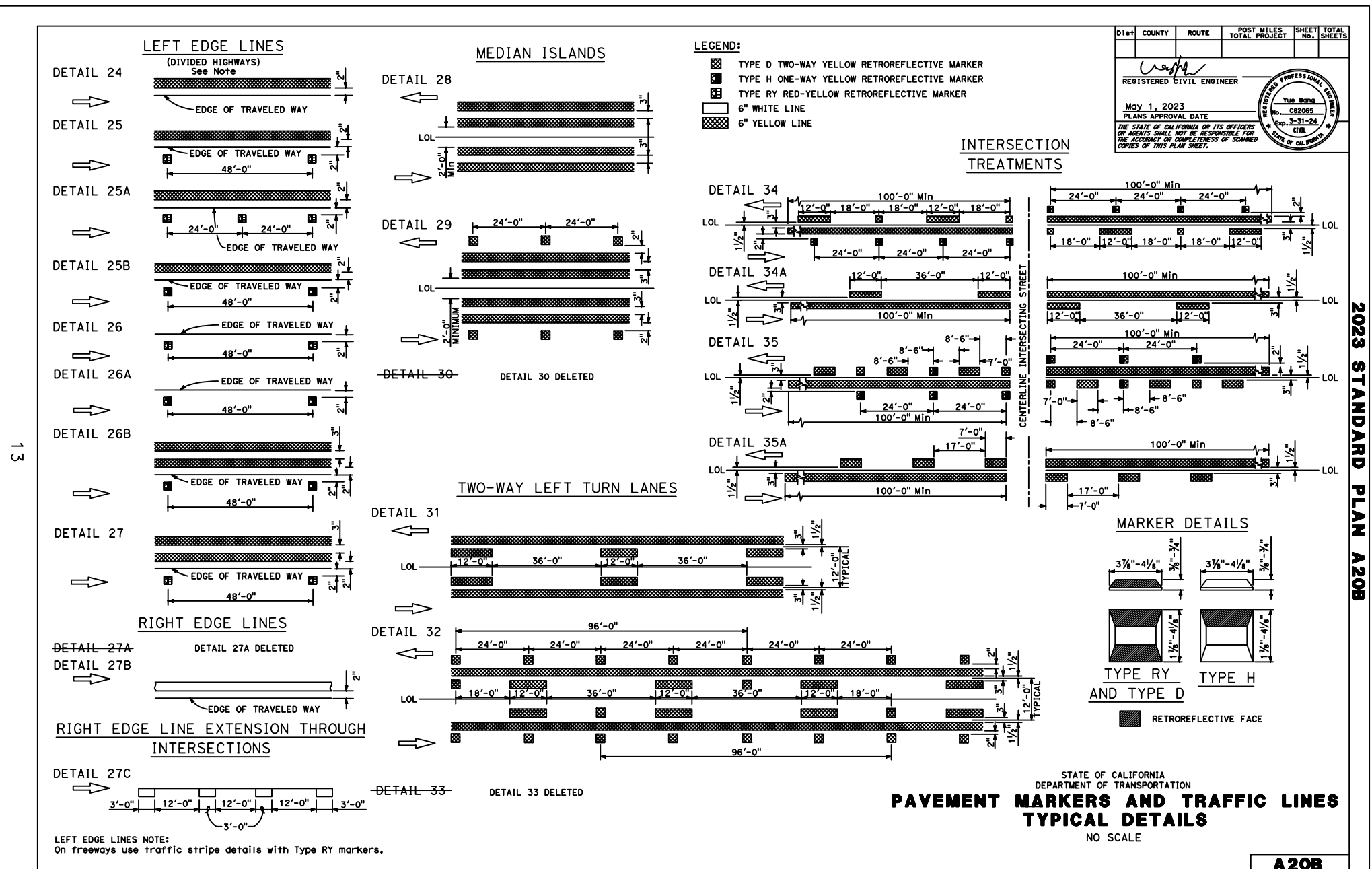
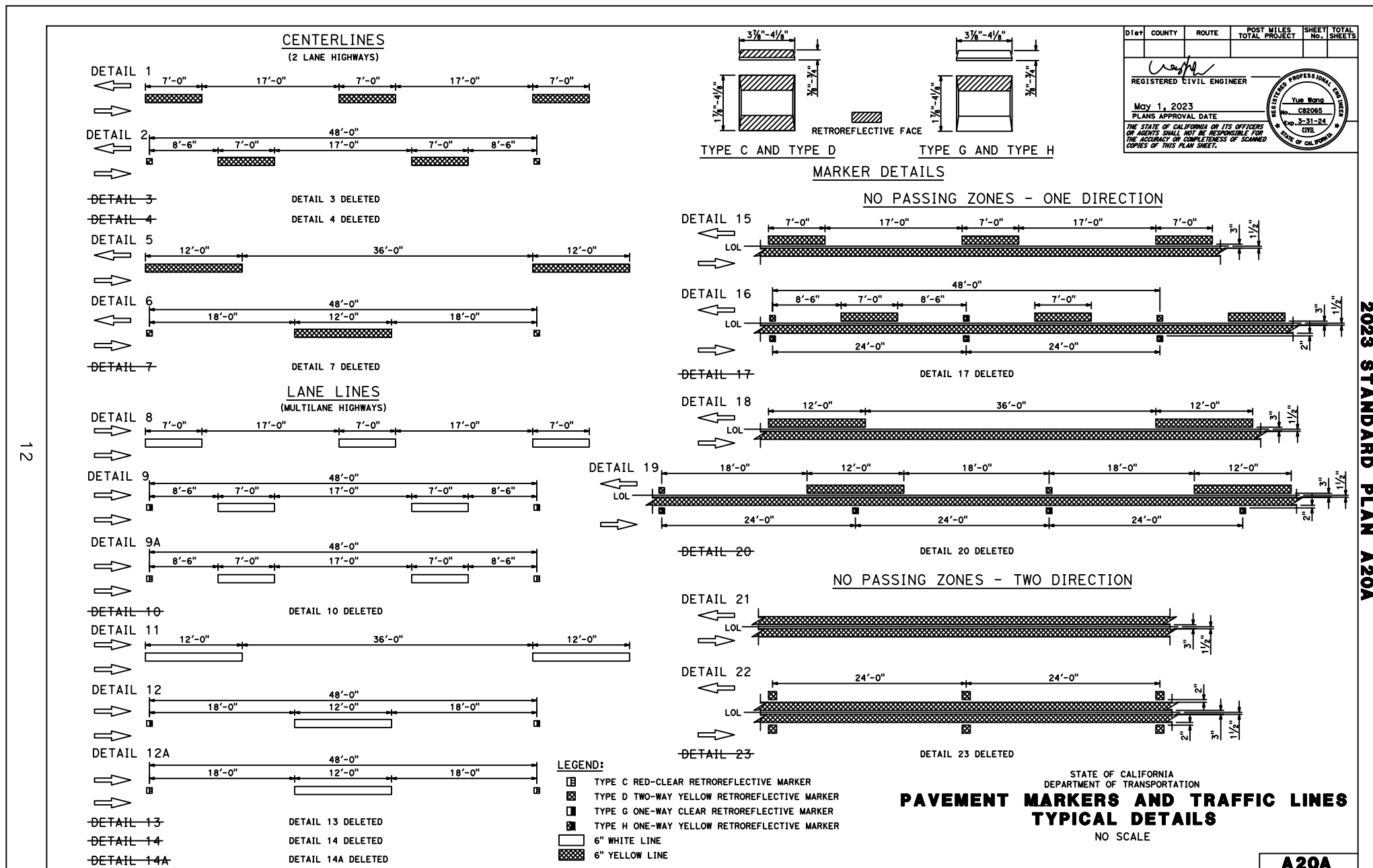

NOTE:
 ALL REFERENCES AND WRITTEN DIMENSIONS SHALL TAKE PREFERENCE OVER SCALED DIMENSIONS AND SHALL BE VERIFIED IN THE FIELD. ANY DISCREPANCY SHALL BE BROUGHT TO NOTICE OF THE ENGINEER PRIOR TO THE COMMENCEMENT OF ANY WORK.

REVIEWED BY:
 STEPHEN FREMMING, P.E.
 PRINCIPAL CIVIL ENGINEER
 9/18/2024
 DATE

APPROVED BY:
 WILLIAM D. MORRIS, RCE 55910
 CITY ENGINEER
 9/18/2024
 PLANS APPROVAL DATE



CITY OF TURLOCK
 ENGINEERING DIVISION
 156 S. BROADWAY, STE 150
 (209) 668-5520

CONSTRUCTION DETAILS
 CAPITAL PROJECT NO. 23-057
 MONTE VISTA BIKE LANE
 IMPROVEMENTS NEAR CSUS

VERIFY SCALE
 BAR IS 1" ON ORIGINAL DRAWING
 0 1/4" 3/4" 1" 1/2"

IF NOT ONE INCH ON THIS SHEET, ADJUST SCALES ACCORDINGLY

DRAWN BY: OM
 REV. BY: SF
 CH. BY: BM
 DATE: 9/17/2024
 SCALE: NOT TO SCALE

SHEET
 6
 OF 7

24

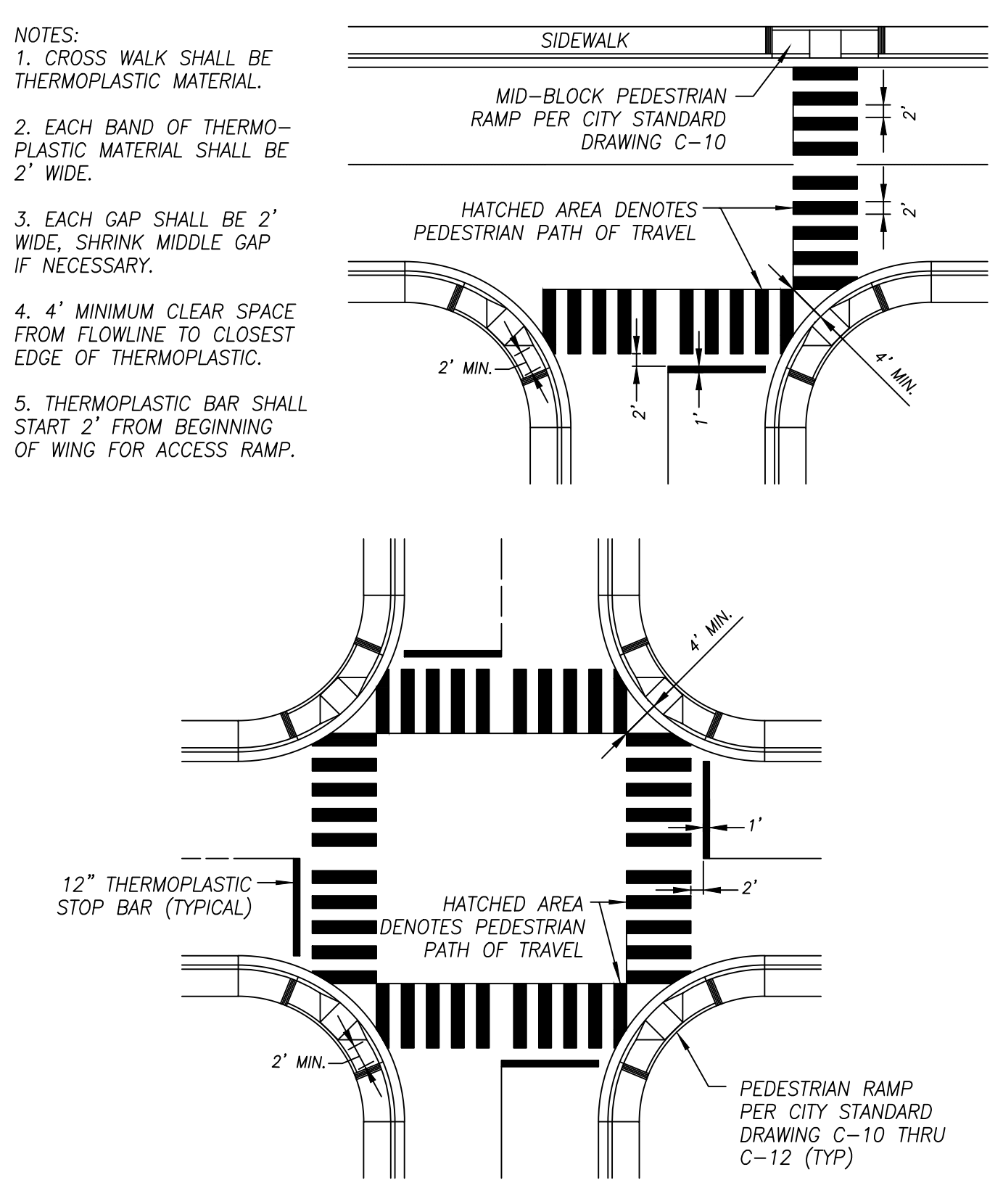
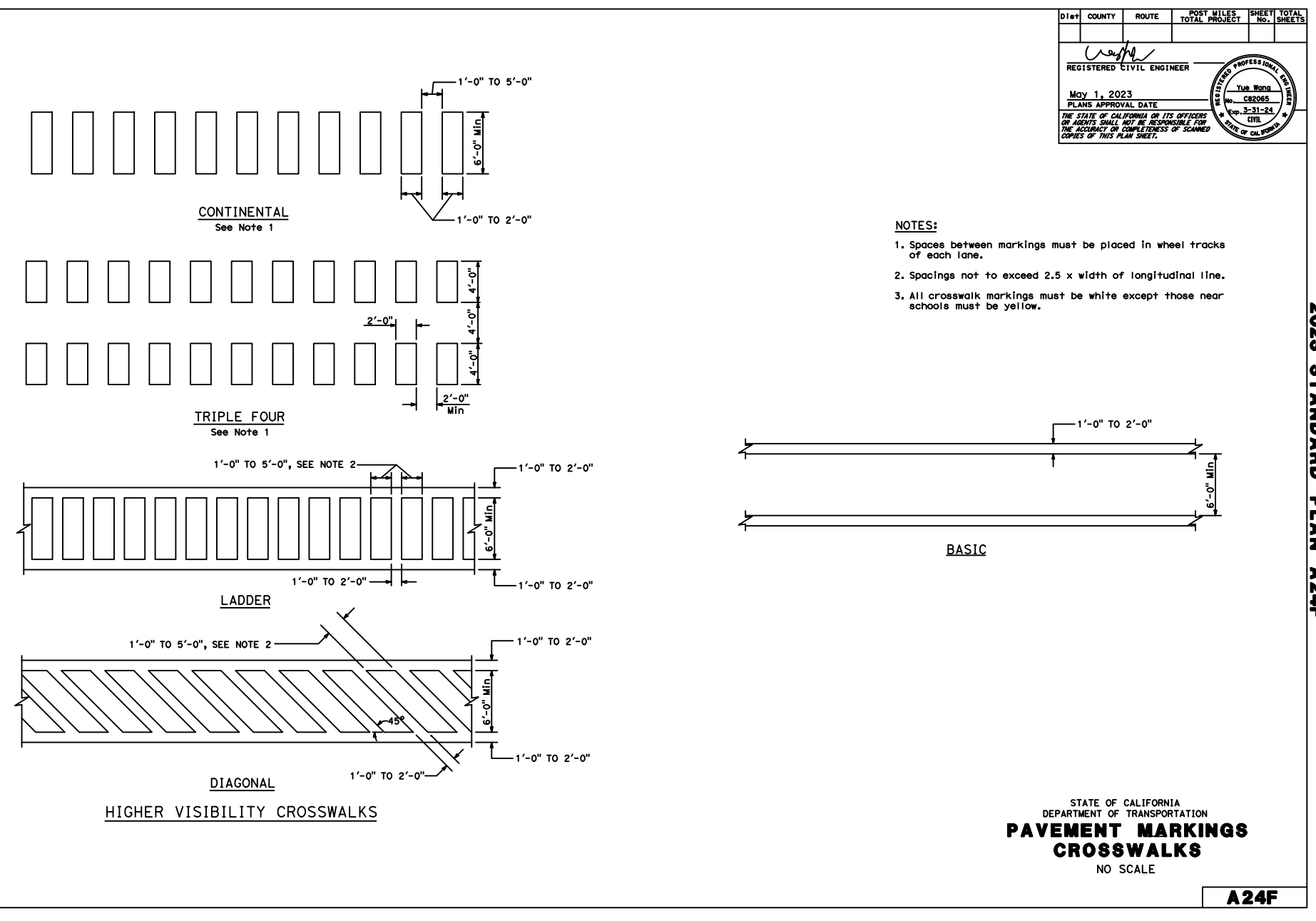

DRAWN BY: AZ		DRAWING NO. C-17	
CHECK BY: NBB		COUNCIL APPROVAL	
SCALE: NONE		DEC, 2015	
APPROVED BY: <i>[Signature]</i> CITY ENGINEER - MICHAEL G. PITCOCK - RCE 52694			

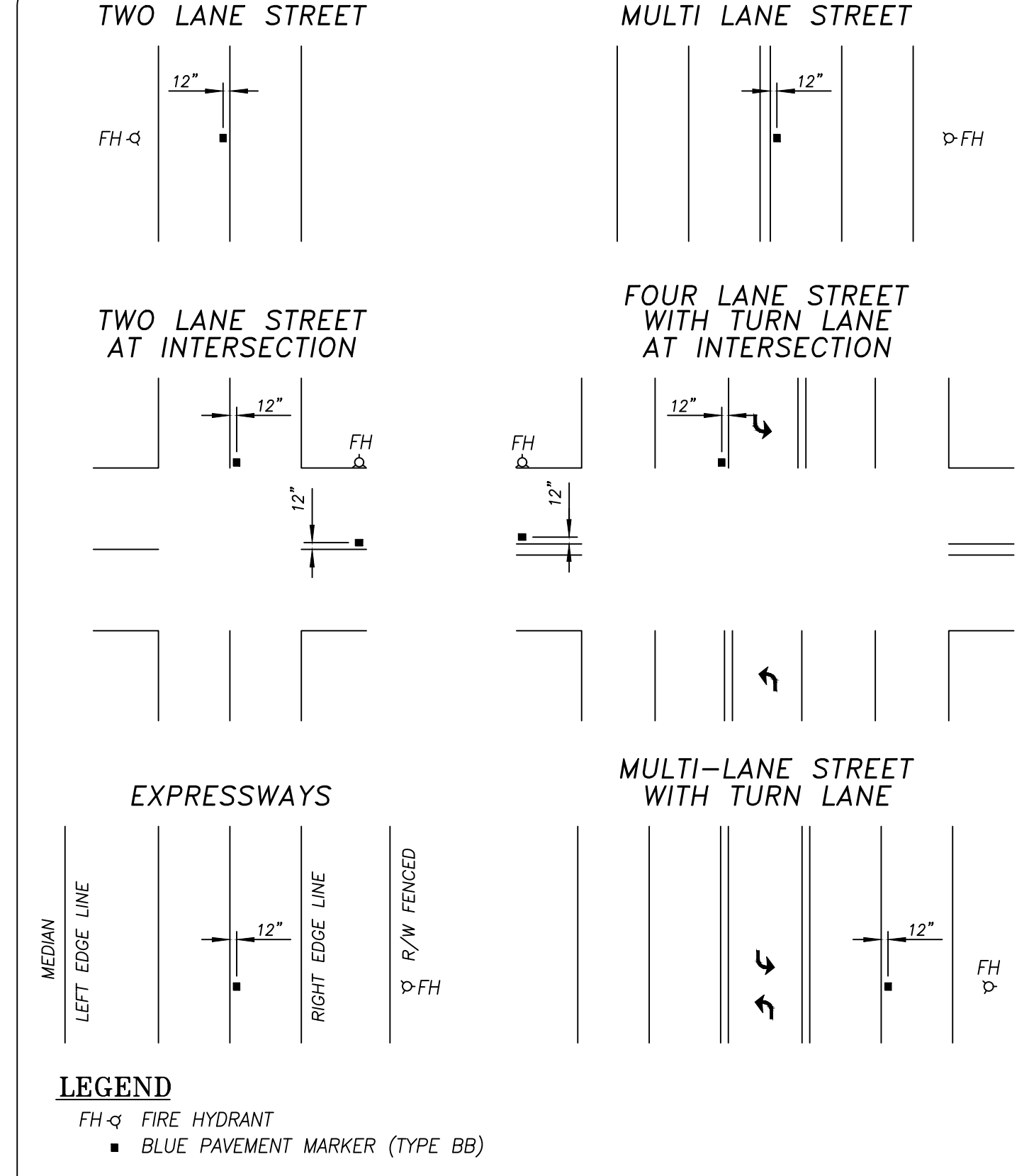

DRAWN BY: JSH		DRAWING NO. W-3	
CHECK BY: NBB		COUNCIL APPROVAL	
SCALE: NONE		DEC, 2015	
APPROVED BY: <i>[Signature]</i> CITY ENGINEER - MICHAEL G. PITCOCK - RCE 52694			

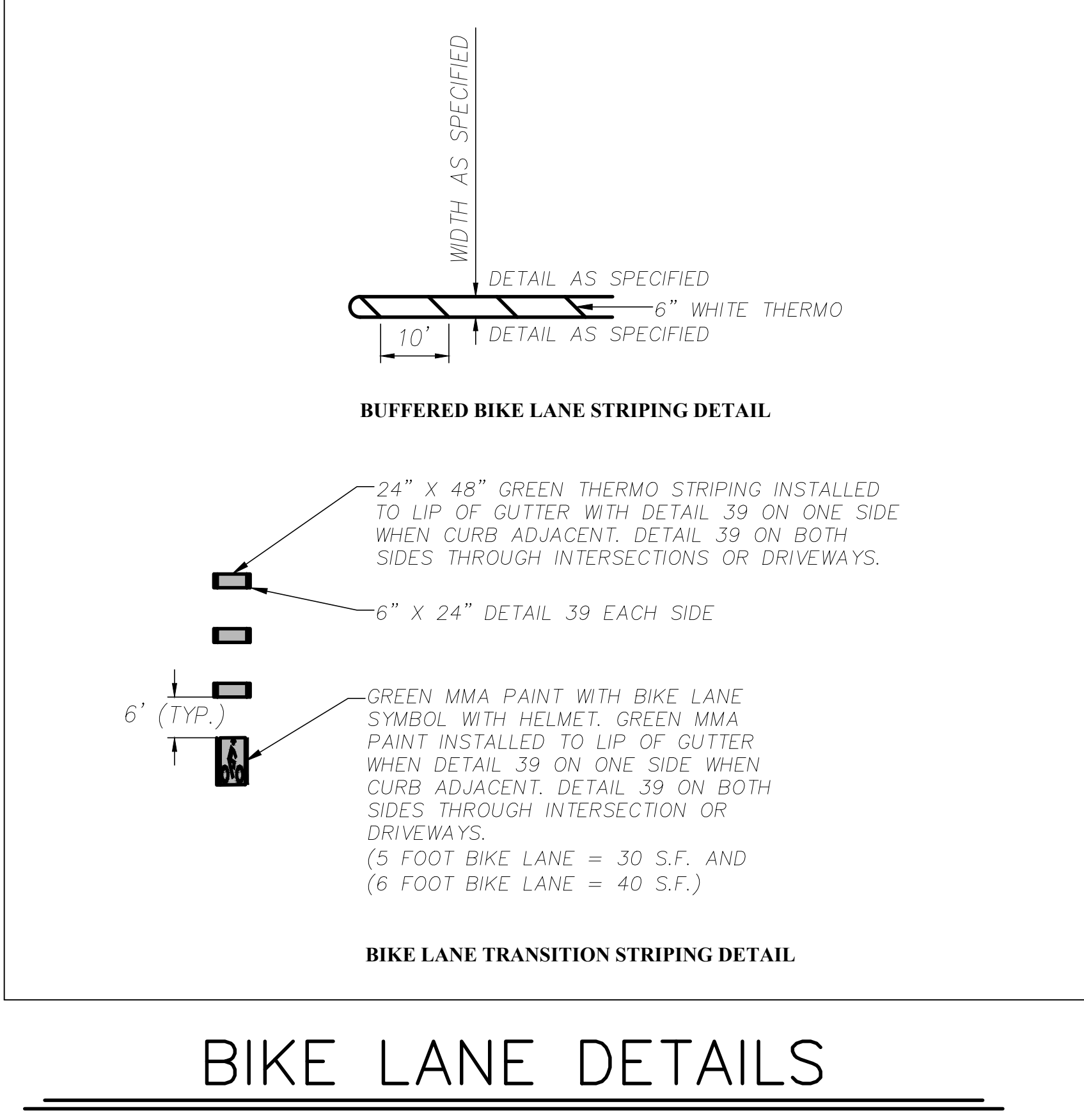
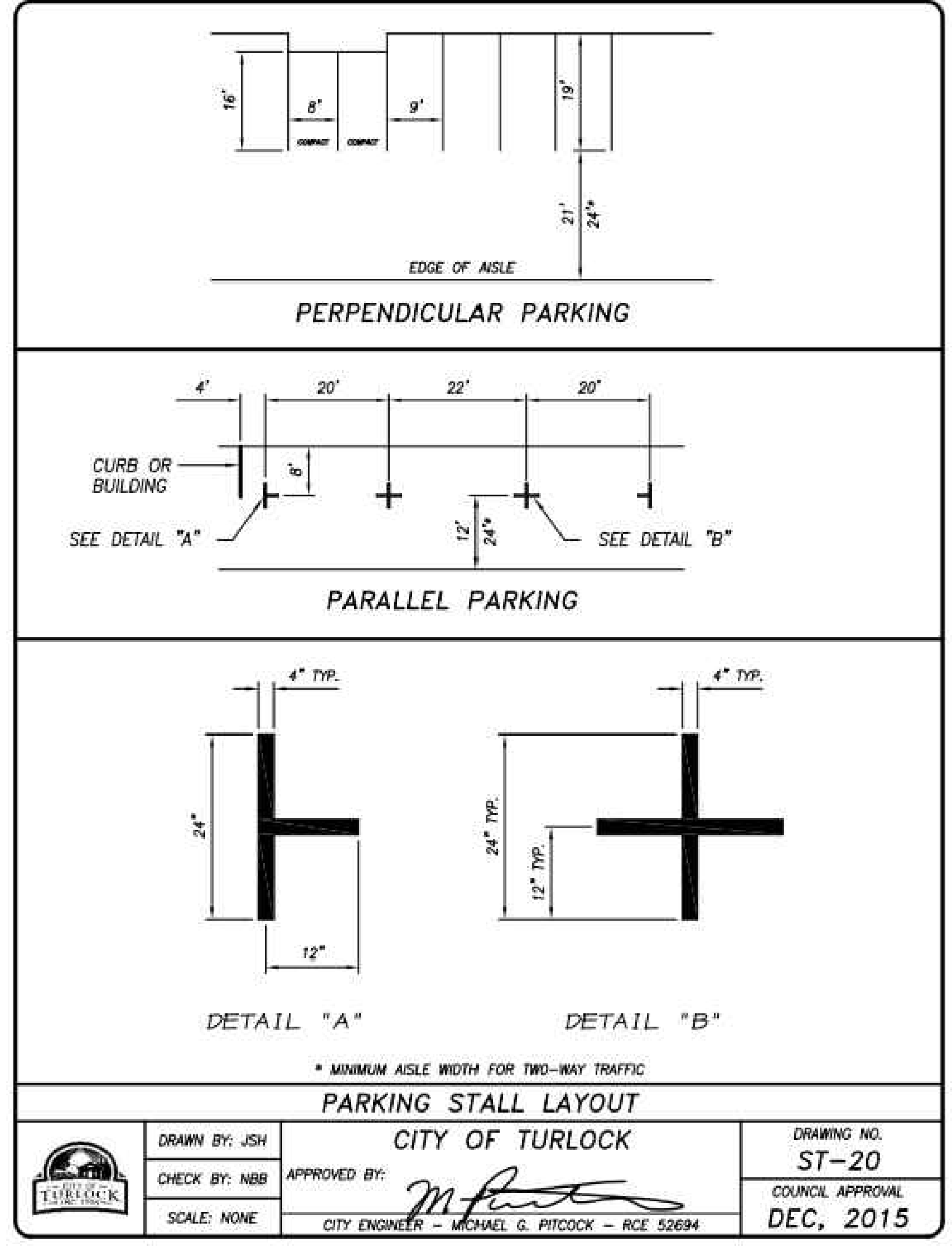

NOTE:
ALL REFERENCES AND WRITTEN DIMENSIONS SHALL TAKE PREFERENCE OVER SCALED DIMENSIONS AND SHALL BE VERIFIED IN THE FIELD. ANY DISCREPANCY SHALL BE BROUGHT TO NOTICE OF THE ENGINEER PRIOR TO THE COMMENCEMENT OF ANY WORK.

REVIEWED BY:
[Signature]
STEPHEN FREMMING, P.E.
PRINCIPAL CIVIL ENGINEER

DATE:
9/18/2024

APPROVED BY:
[Signature]
WILLIAM D. MORRIS, RCE 55910
CITY ENGINEER

DATE:
9/18/2024

PLANS APPROVAL DATE



**CITY OF TURLOCK
ENGINEERING DIVISION**
156 S. BROADWAY, STE 150
(209) 668-5520

CONSTRUCTION DETAILS
CAPITAL PROJECT NO. 23-057
MONTE VISTA BIKE LANE
IMPROVEMENTS NEAR CSUS

VERIFY SCALE
BAR IS 1" ON ORIGINAL DRAWING
0 1/4" 3/4" 1" 1/2"

IF NOT ONE INCH ON THIS SHEET, ADJUST SCALES ACCORDINGLY

DRAWN BY: OM

REV. BY: SF

CH. BY: BM

DATE: 9/17/2024

SCALE: NOT TO SCALE

SHEET

7

OF 7